



Maxwell

Year	2014
Designer	Massimo Castagna

Maxwell table is defined by a simple and essential shape that highlights the exceptional personality of the special stone finishes. These completely envelop the internal steel frame, making it invisible. The grains in the marble, the varying shades of colours, and the mosaic of minerals — the result of the millenary process of the metamorphosis of the stone — are skillfully brought to light in all their beauty.

The stone table top's rounded corners and slightly tapered edge create a soft contrast with the distinctly linear and angled legs. This balance imbues Maxwell table with an elegant lightness, emblematic of Massimo Castagna's approach to materials and innovative designs.

Dimensions

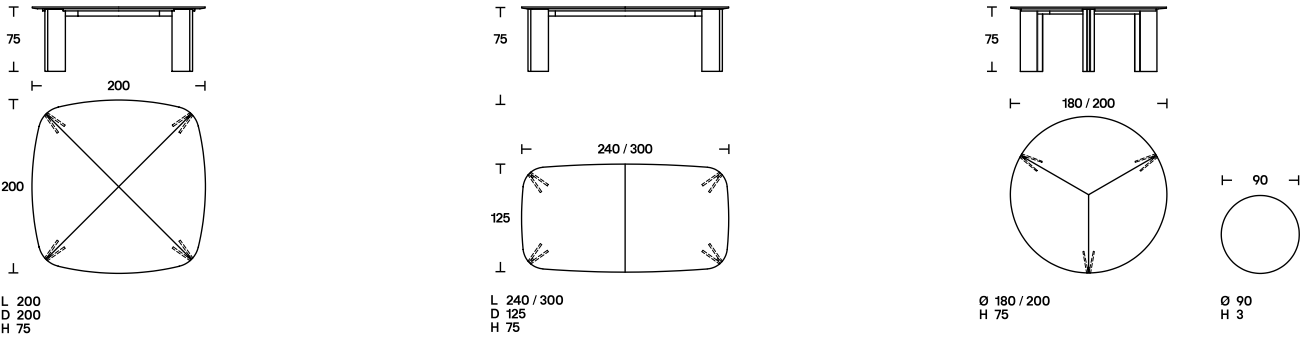

Finishes

Top and base: matt Carrara statuario white marble, gold Calacatta, Levanto red marble, Alpi Green marble.
Glossy polyester finishing available on request.
Frame, inner legs and top support in slate grey finish.

Top and base

Matt Carrara Statuario white marble	MR04
Matt Calacatta gold marble	MR09
Matt Alpi Green marble	MR07
Matt Levanto red marble	MR06

Discover all product finishes